

Configuration Sheet

Internal fitting kit (K4.42) layout

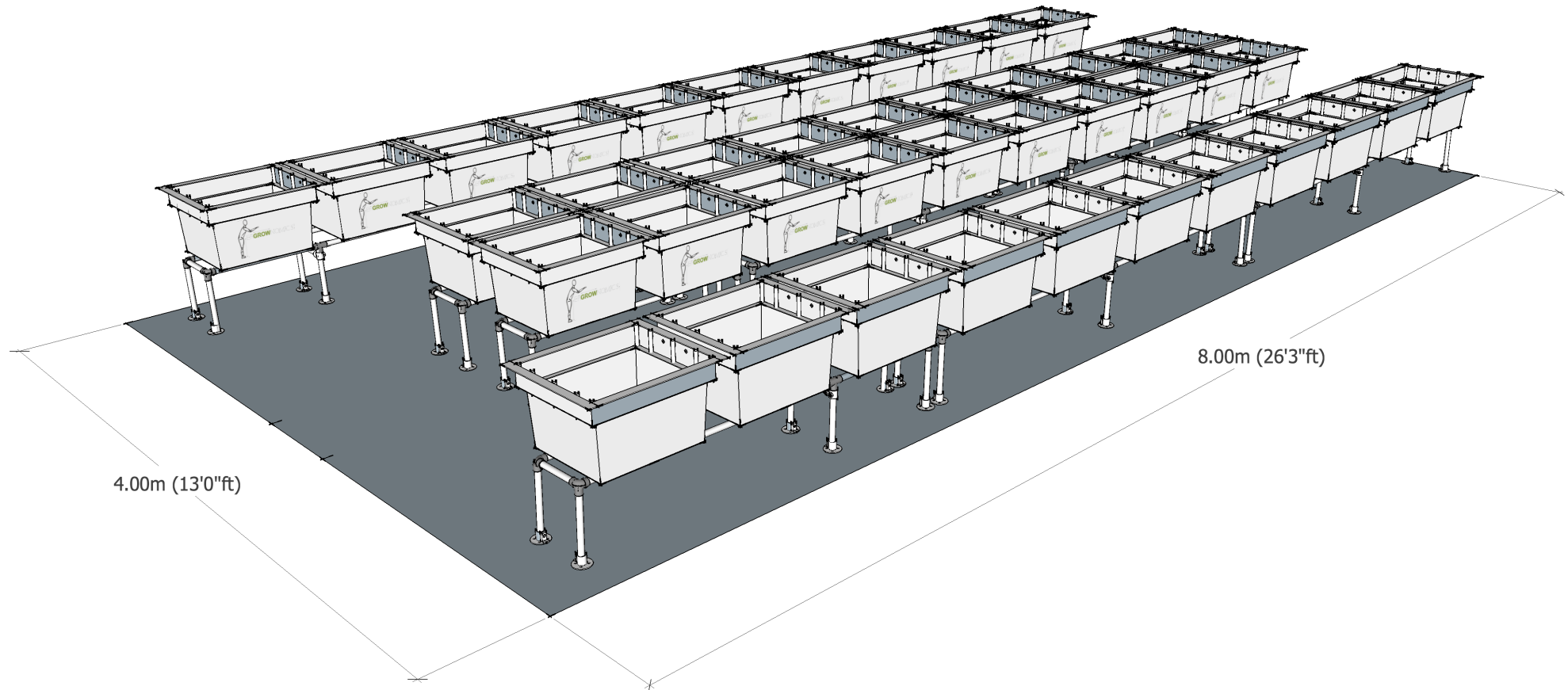

LAYOUT OPTION 1:



LAYOUT OPTION 2:

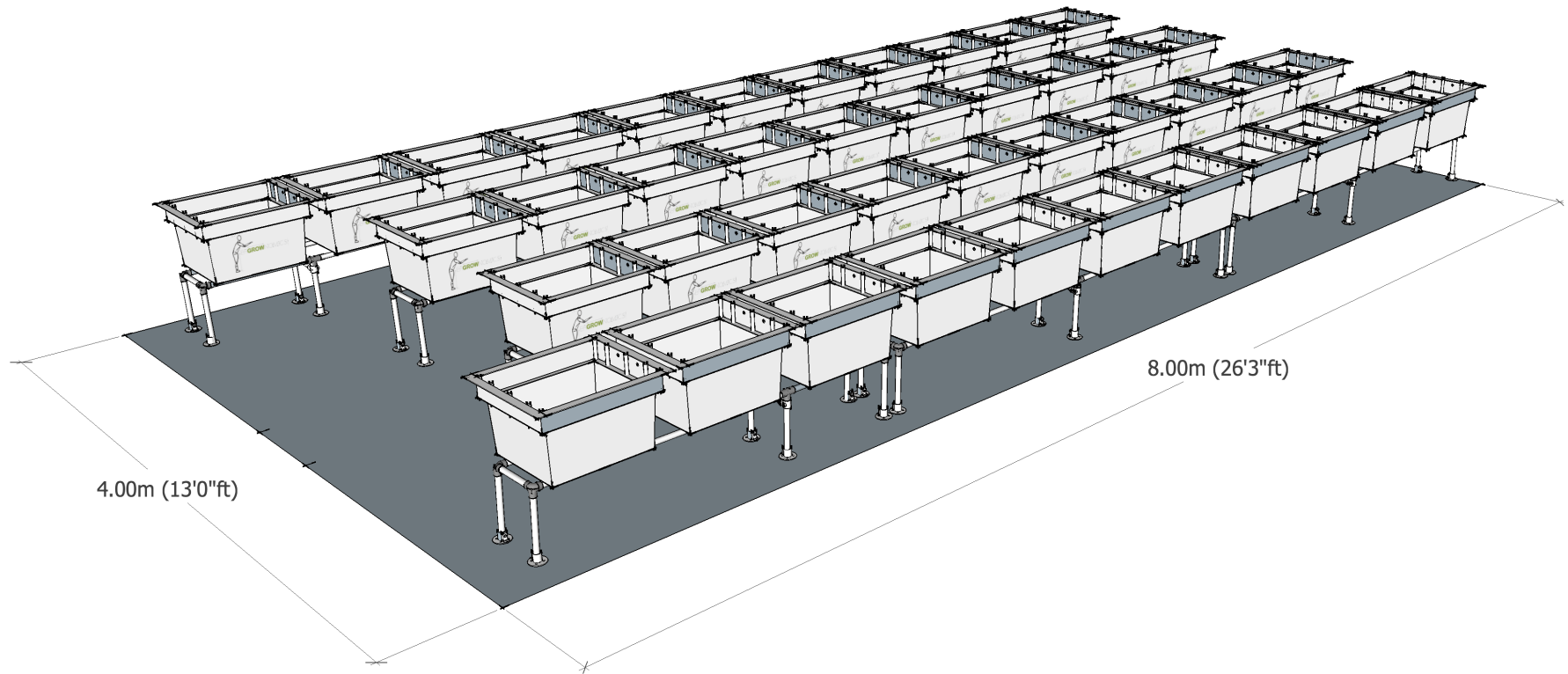

Specification Sheet

Internal fitting kit (K4.42) contents



	Unit
PLANTERS	
Two Planter (frame only)	2
Three Planter (frame only)	2
Four Planter (frame only)	8
Horticultural container (577 mm (l) x 588 mm (w) x 385 mm (d) internal dimensions) (85 litre soil capacity)	42
Hexagonal key ('L' shaped 1/4" ductile carbon steel to DIN 11 with precision square cut ends for accurate contact to hex plug wall sides)	1
DRAINAGE	
Thermally bonded non woven geotextile membrane (110 grams m ²) (510 mm (l) x 425 mm (w)) (0.22 m ²) for lining base of container / protecting 'bean bag'	42
Heavy duty PVC mesh bag (550 grams m ²) (570 mm (l) x 280 mm (w) (0.16 m ²) (gravel not supplied)	42

IRRIGATION

Lock Type fitting quick coupling - threaded elbow, 16 mm (external diameter)	3
Lock Type fitting quick coupling - threaded tee, 16 mm (external diameter)	7
Lock Type fitting quick coupling - threaded straight, 16 mm (external diameter)	8
Standard length pipe interconnector to fittings along irrigation manifold (67 mm) Medium duty Rain Bird LDPE 16mm solid black irrigation pipe (4 bar)	4
Medium duty Rain Bird LDPE 16mm solid black irrigation pipe (4 bar) for multiple rows of planter units. (To be cut to length in situ) (m)	4.0
Rain Bird XF Series dripline 16 mm (external diameter) with emitters at 33 cm centres (2.3l/hr flow rate) for multiple combinations of planter units. (To be cut to length in situ) (m)	66.0
Barbed plug 16 mm (external diameter) / 13.6 mm (internal diameter)	8
Atelco 16 mm tubing clamp with ratchet closure to secure dripline over plug)	8
Container top to floor short length pipe (0.8 m) Medium duty Rain Bird LDPE 16mm solid black irrigation pipe (4bar) for connection to external water supply	1

PLANT TRAINING

Adjustable support (aluminium) (12 mm diameter x 360 mm length)	2
Vinyl stop end to adjustable support to provide eye protection (10 mm x 25.40 mm S-Cap)	2
Rubber-'O' ring (BS309 EPDM 70 ShA)	2
Elastic supporting lines (1,240 mm length x 3.0 mm diameter) with short brass aglets fitted	1
Spherical cord lock black nylon for 3-4 mm diameter cord	1

Please note that this product specification is subject to change at the manufacturer's discretion.